

Level probe

CLP-G5A2_ _

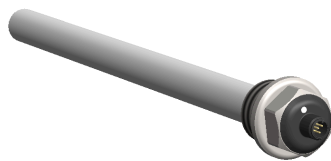

Product image



Dimensional drawing

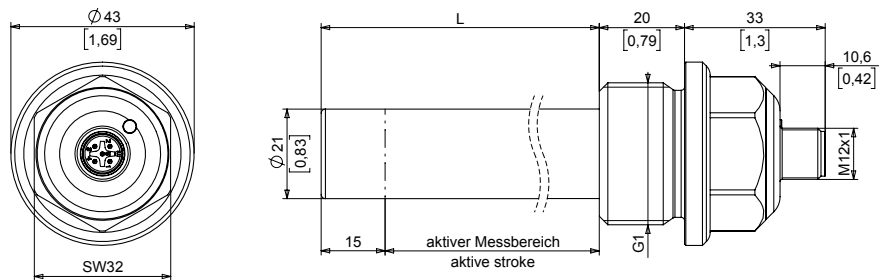

Plug M12, 5-pin

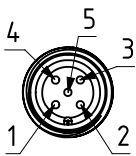

Pin	Signal	Description
1	U _v	+24V DC supply voltage
2	Switching output or analog output	PNP / NPN; NO / NC 4...20 mA / 0...10 V
3	GND	0V
4	Switching output IO-Link communication	PNP / NPN; NO / NC
5	Switching output	PNP / NPN; NO / NC

Technical specifications

Technical specifications at 24 V and 20 °C	
Connection	Plug M12
Operating voltage	DC 24 V (19.2 to 28.8 V)
Power consumption	typically 29 mA
Load current	typically 50 mA max. 200 mA
Operating temperature	0°C (32°F)...+70°C (158°F)
Analog output	4...20 mA / 0...10 V
Switching output	NPN/PNP/Push-Pull, NO/NC switchable



Technical specifications at 24 V and 20 °C

Switching point position	adjustable
Measurement accuracy	± 2% of upper range limit
Repeat accuracy	± 1% of upper range limit
Response time	<1 s
Degree of protection IP	IP67
Compressive strength	3 bar (option: 10 bar)
Communication interface	IO-Link specification V1.1
Measuring principle	Capacitive
Process connection	V4A
Probe rod	PTFE
DK medium	>1.8 (dielectric constant ϵ_r)

Legal notice

The information contained in this document regarding sensors, SENSORswitches, devices, applications, and software is for informational purposes only and may be updated at any time. It is your responsibility to ensure that your applications conform to your specifications.

CAPTRON does not make any representations or warranties, expressly or implied, with respect to the information, including but not limited to its content, condition, quality, and suitability for a particular purpose. CAPTRON rejects any liability arising from this information and its use.

The use of CAPTRON sensors, SENSORswitches, devices, applications, and software in life support and/or safety applications is solely at the risk of the end consumer who purchased the product. The end consumer further agrees to defend, indemnify, and hold CAPTRON harmless from any damages, claims, actions, or expenses arising from such use.

Unless stated otherwise, no licenses to CAPTRON's intellectual property rights are transferred, implied or otherwise.

Trademark

The CAPTRON, CANEO, and oneGRID names and logos are registered trademarks of CAPTRON in various countries and are the property of CAPTRON Electronic GmbH.

All other trademarks mentioned herein are the property of their respective owners.

© 2022, CAPTRON Electronic GmbH, all rights reserved.